



OIL DRAIN VALVE
OIL DRAIN VALVE



OIL DRAIN VALVE

OIL DRAIN VALVE

TYPE: SODV

PORT SIZE: 1/2" & 3/4"

CONNECTION : Socket Weld.

REFRIGERANT

Suitable for all common refrigerant including R-717(Ammonia), R-13 a, R-404, Neutral, gaseous and liquid media.

INTRODUCTION

This is fast closing oil drain valve. The lever handle is loaded with spring. To open the valve, the lever is pressed manually and it closes immediately when the lever is released. This prevent any chance of valve remaining open accidentally and refrigerant escaping out in atmosphere. The bolted bonnet makes it easy for maintenance. Steel plate under lever is provided for smooth operation of the lever.

APPLICATION

It is used to remove oil from the oil separator safely without any loss of refrigerant.

SPECIFICATIONS

Body	:	ASTM A105
Stem	:	SS
Bonnet	:	Steel (bolted)
Seat	:	PTFE
Safe working pressure	:	365 psig (25 bar)
Temp. Range	:	-40 to +116 ° C
Flow	:	Uni-derection(side entry to bottom exist)



SUPERFREEZE

OIL DRAIN VALVE

INSTALLATION INSTRUCTIONS

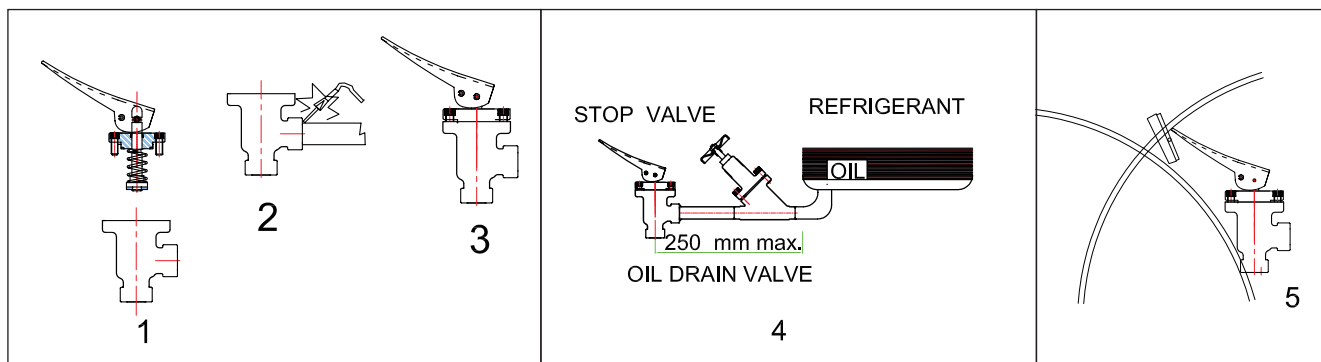
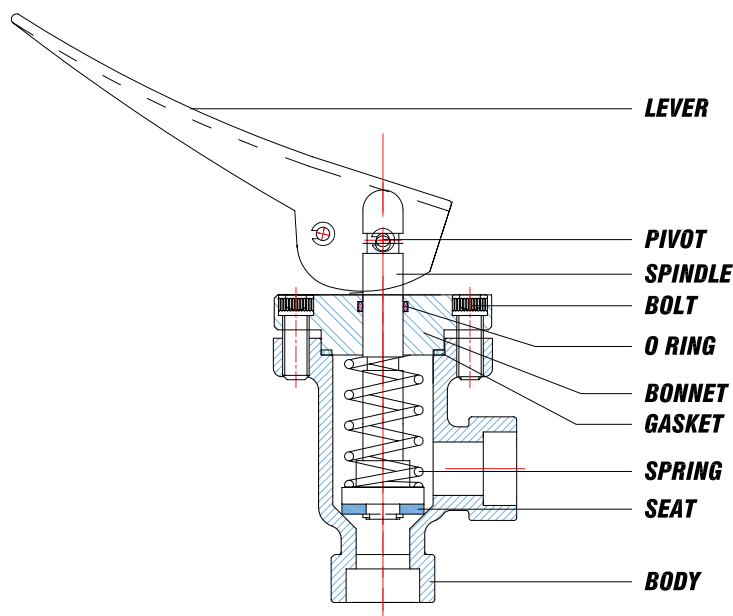

1. Oil drain valve should be installed in vertical position only. (lever toward sky)
2. Oil drain valve should be installed after stop valve. Distance between stop valve and Oil drain valve should be kept minimum.
3. Inlet of Oil drain valve is from side and out let is from bottom.
4. Welding must be done after removing bonnet.
5. Do not use handle or any other parts of valve for earthing.
6. After welding clean inside of valve and bonnet assembly before re-installation. Tight the bolts equally.
7. Keep stop valve closed all the time. When oil is required to be drained, first open stop valve and then drain valve. After draining oil, close the stop valve.

SUPERFREEZE INDIA (P) LTD

An ISO 9001 : 2015 Certified Company

122, Qutab Plaza, DLF Phase-I, Gurgaon -122002, Haryana, India
Tel : +91-124-4301636

E mail : sales@superfreeze.com Website : www.superfreeze.com